

- i READ ALL INSTRUCTIONS THOROUGHLY BEFORE INSTALLATION**
- (*) INSTRUCTIONS WITH (*) ONLY APPLY TO CASES WITH WHEELS (PELICAN 1535 CASE EXCLUDED)**
- ! ALWAYS WEAR PROPER SAFETY EQUIPMENT WHEN OPERATING POWER TOOLS**

RECOMMENDED TOOLS

- POWER DRILL
- PENCIL
- 1/4" DRILL BIT
- RUBBER Mallet
- 7/16" SOCKET
- SOCKET WRENCH

INCLUDED HARDWARE

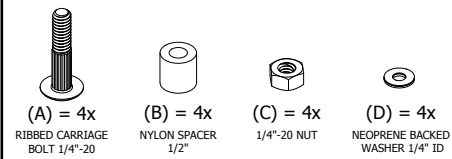

STEP 1

- (*) REMOVE WHEEL ASSEMBLY FROM CASE BY UNSCREWING MOUNTING BOLTS (LOCATION VARIES BY CASE).
- CENTER THE PANEL INSIDE THE CASE AS PICTURED IN STEP 1.
- MARK 1/4 INCH HOLE LOCATIONS ON FLOOR OF THE CASE.
- DRILL HOLES.

STEP 2

- PLACE WASHER (D) OVER BOLT, NEOPRENE SIDE FACING THE CASE.
- INSERT BOLT (A) + WASHER (D) THROUGH HOLE IN CASE.
- GENTLY TAP BOLT (A) INTO BOTTOM OF CASE WITH Mallet.

i ALTERNATE BOLT INSTALLATION (RECOMMENDED):

- ORIENT THE CASE AND BOLT AS PICTURED IN STEP 2.
- PLACE A SPACER OR WOOD BLOCK BETWEEN HEAD OF BOLT AND TABLE SURFACE, TO PREVENT DAMAGE TO SURFACE.
- INSTALL BOLTS ONE AT A TIME. TAP CASE WITH HAMMER OR PRESS TO DRIVE IT DOWN OVER THE BOLT (A) AND WASHER (D).
- PLACE SPACER (B) OVER BOLT (A).
- PLACE A STANDARD SOCKET OVER SPACER (B).
- GENTLY TAP SPACER (B) DOWN ONTO CARRIAGE BOLT (A), UNTIL CONTACTING THE CASE FLOOR.
- (*) REATTACH WHEEL ASSEMBLY.

STEP 3

- ALIGN PANEL MOUNTING HOLES WITH INSTALLED BOLTS (A) AND PLACE PANEL ON TOP OF SPACERS (B).
- PLACE AND SECURE NUTS (C) USING SOCKET WRENCH.

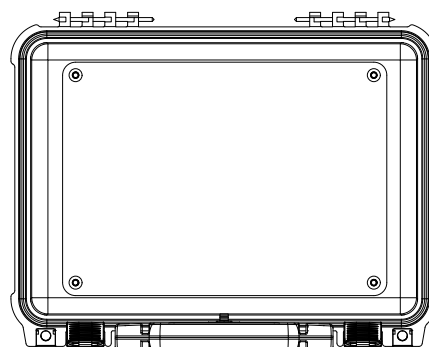

STEP 1
(SHOWN WITHOUT LID)

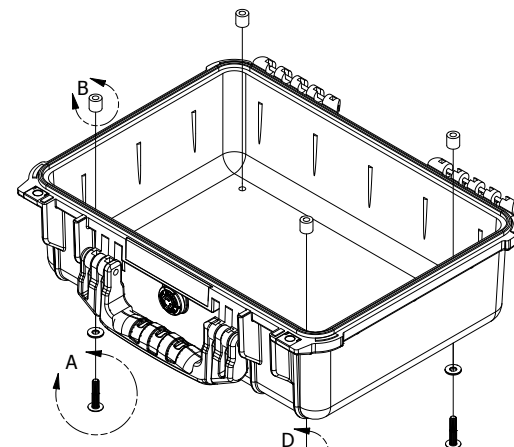

STEP 2
(SHOWN WITHOUT LID)

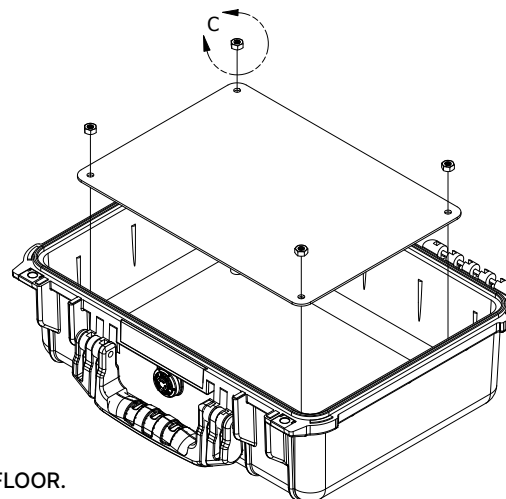

STEP 3
(SHOWN WITHOUT LID)

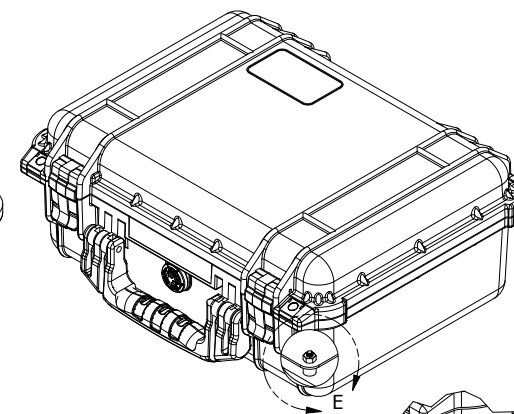

FINISH
(WITH CUTAWAY VIEW)

DETAIL E
SCALE 2 : 3